

Tilt Sensors

With 4 ... 20 mA current output for a measuring range of $\pm 10^\circ$, $\pm 20^\circ$, $\pm 45^\circ$ and $\pm 80^\circ$

Tilt switches and tilt sensors are increasingly deployed in construction machinery, agricultural technology, commercial vehicle technology and materials handling equipment.

Tilt sensors are used to capture positional data such as tilt angle which is then analysed via an analogue output.

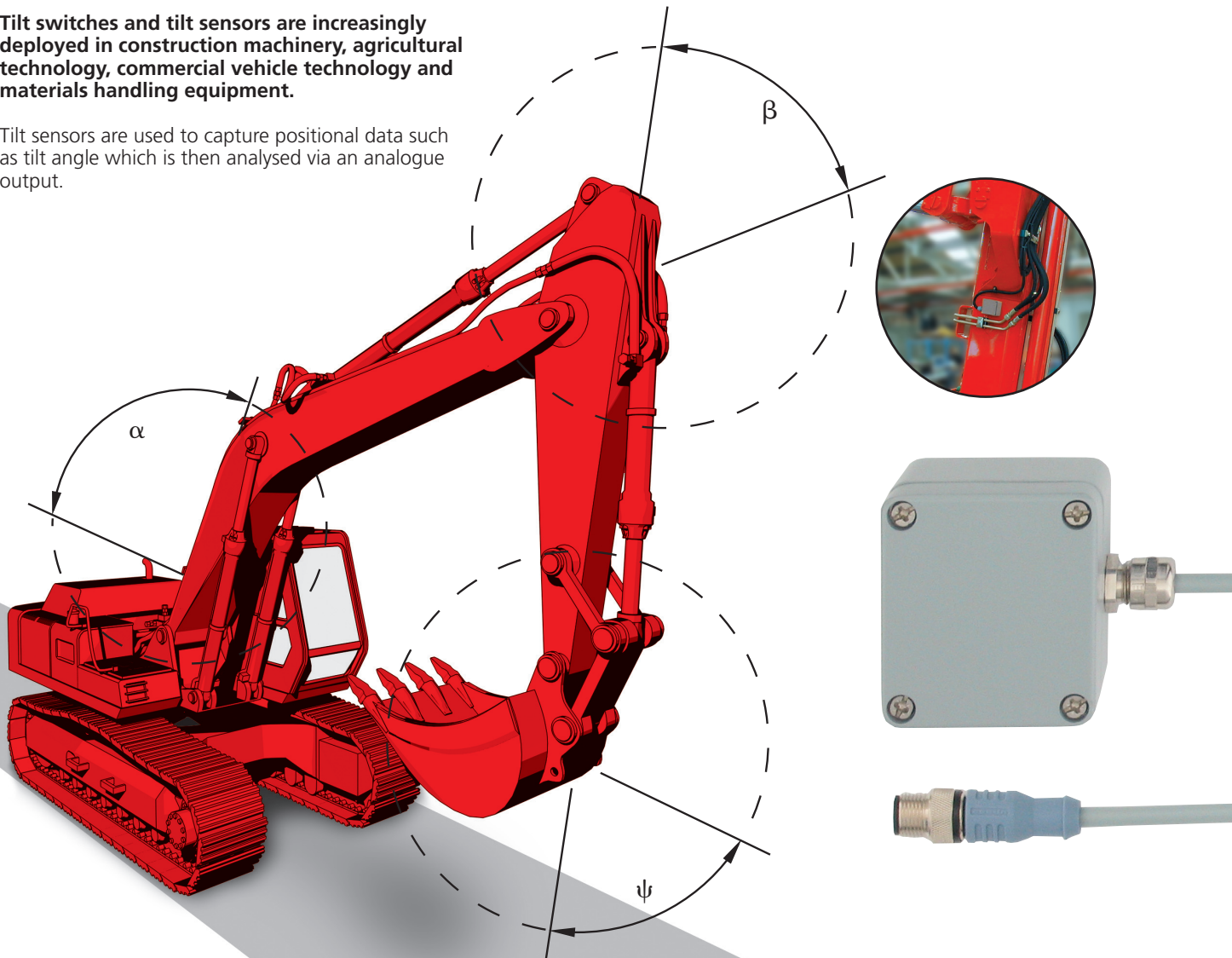

Fully electronic tilt sensors from Bernstein are the first choice when it comes to replacing existing mercury switches with electronic solutions and thereby offsetting the disadvantages of those switching contacts already in use. These issues include sensitivity to vibrations, inaccurate angle capture, high inertia and heavy metal load.

Your contact at Bernstein AG:

Marcus Scholz
Phone +49 571 793 - 100
Fax +49 571 79371 - 100
m.scholz@de.bernstein.eu

Requirements for outdoor use:

- Extended temperature range -40°C to $+80^\circ\text{C}$ (worldwide use)
- Weathering resistance
- Resistant to oils, dust, etc.

Features:

- Rugged metal housing 58 x 64 x 32 mm
- EMC-compatible switching design
- Other measuring ranges upon request
- Fully electronic design eliminates machine vibration for functional reliability

Electrical data

Working range	S	$\pm 80^\circ$ (other working ranges upon request))
Mounting		vertical, cable down
Current output	I	4 ... 20 mA
Voltage output	U	Voltage output upon request
Repeat accuracy	R	$\leq 0,3\%$ full scale
Working resistance	R _L	0 ... 250 Ω
Measurement error		$\pm 5\%$ full scale
Filter time	t	500 ms
Operational voltage range	U _B	10-53 VDC; including ripple
No-load supply current	I ₀	≤ 10 mA
False polarity protection		yes

Electromagnetic compatibility (EMC)

Electromagnetic field test	IEC 61000-4-3	10 V/m
Electrostatic discharge test	IEC 61000-4-2	4 kV
Electrical fast transient immunity test (Burst)	IEC 61000-4-4	2 kV, coupling clamp
Impulse voltage withstand ability (Surge)	IEC 61000-4-5	1000 V, 1,2/50 μ s at R _i = 42 Ohm
Radiated disturbance field strength	EN 55011	≤ 40 dB (μ V/m)

Mechanical data

Enclosure	58 x 64 x 36 mm Aluminium, coated
Ambient air temperature	-40 °C ... +80 °C (cable fixedmounted ; U _B = 24 V)
Type of protection	IP67 (NEMA 4)
Termination type	Cable 3 x 0,34 mm ² x 0,2 m $\pm 5\%$; with plug connector M12x1
Shock	10-55 Hz; a = 1 mm
Vibration	30 g; t _{stoss} = 11 ms

EC conformity

Wiring diagram

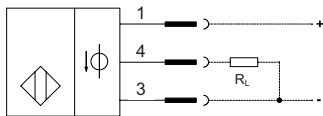

Characteristic

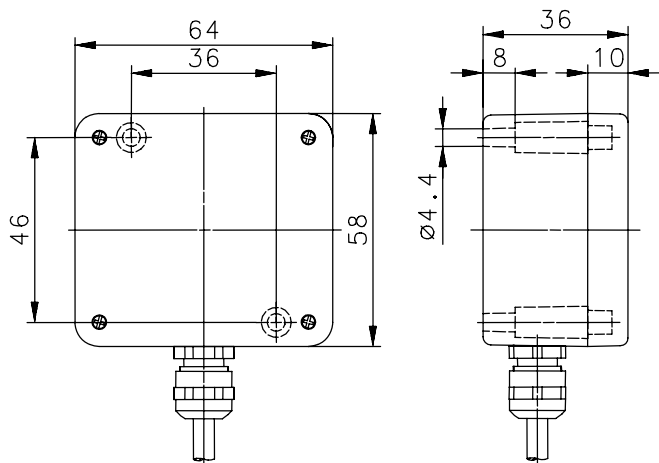
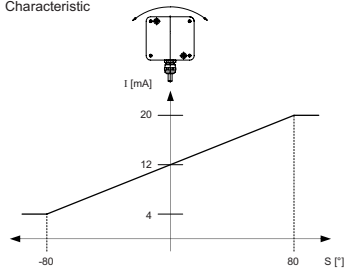
**International Headquarters****Germany****Bernstein AG**

Tieloser Weg 6
D-32457 Porta Westfalica
Phone +49 571 793-0
Fax +49 571 793-555
info@de.bernstein.eu

Denmark**Bernstein A/S**

Sindalsvej 30
DK-8240 Risskov
Phone +45 7020 0522
Fax +45 7020 0177
info@dk.bernstein.eu

Italy**Bernstein S.r.l.**

Via del pero 12a/b
I-24040 Levate (BG)
Phone +39 035 4549037
Fax +39 035 4549647
info@it.bernstein.eu

Austria**Bernstein GmbH**

Kurze Gasse 3
A-2544 Leobersdorf
Phone +43 2256 62070-0
Fax +43 2256 62618
info@at.bernstein.eu

Switzerland**Bernstein (Schweiz) AG**

Steinhaldenstrasse 14
CH 8954 Geroldswil
Phone +41 44 775 71 71
Fax +41 44 775 71 72
info@ch.bernstein.eu

France**Bernstein S.A.R.L.**

Tieloser Weg 6
D-32457 Porta Westfalica
Phone +33 1 64 66 32 50
Fax +33 1 64 66 10 02
info@fr.bernstein.eu

Netherlands**Bernstein BV**

Tieloser Weg 6
D-32457 Porta Westfalica
Phone +31 314 366088
Fax +31 314 361256
info@nl.bernstein.eu

Great Britain**Bernstein Ltd (UK)**

Unit 1, Westgate Park
Tintagel Way
Westgate
Aldridge
West Midlands
WS9 8EX
Phone +44 1922 744999
Fax +44 1922 457555
info@uk.bernstein.eu

China**Bernstein Safe Solutions (Taicang) Co., Ltd.**

North 38, Dongting Road,
Taicang City
Development Area,
Taicang 215400
Jiangsu Province, P.R. China
Phone +86 512 81608180
Fax +86 512 81608181
info@bernstein-safesolutions.cn

Hungary**Bernstein Kft.**

Fehér utca 10
1106 Budapest
Phone +36 1 434 2295
Fax +36 1 434 2299
info@hu.bernstein.eu